

+ 818.65' (USGS DISK)

n/f
LITTLETON POST OFFICE
1/1
T.M. 78-111

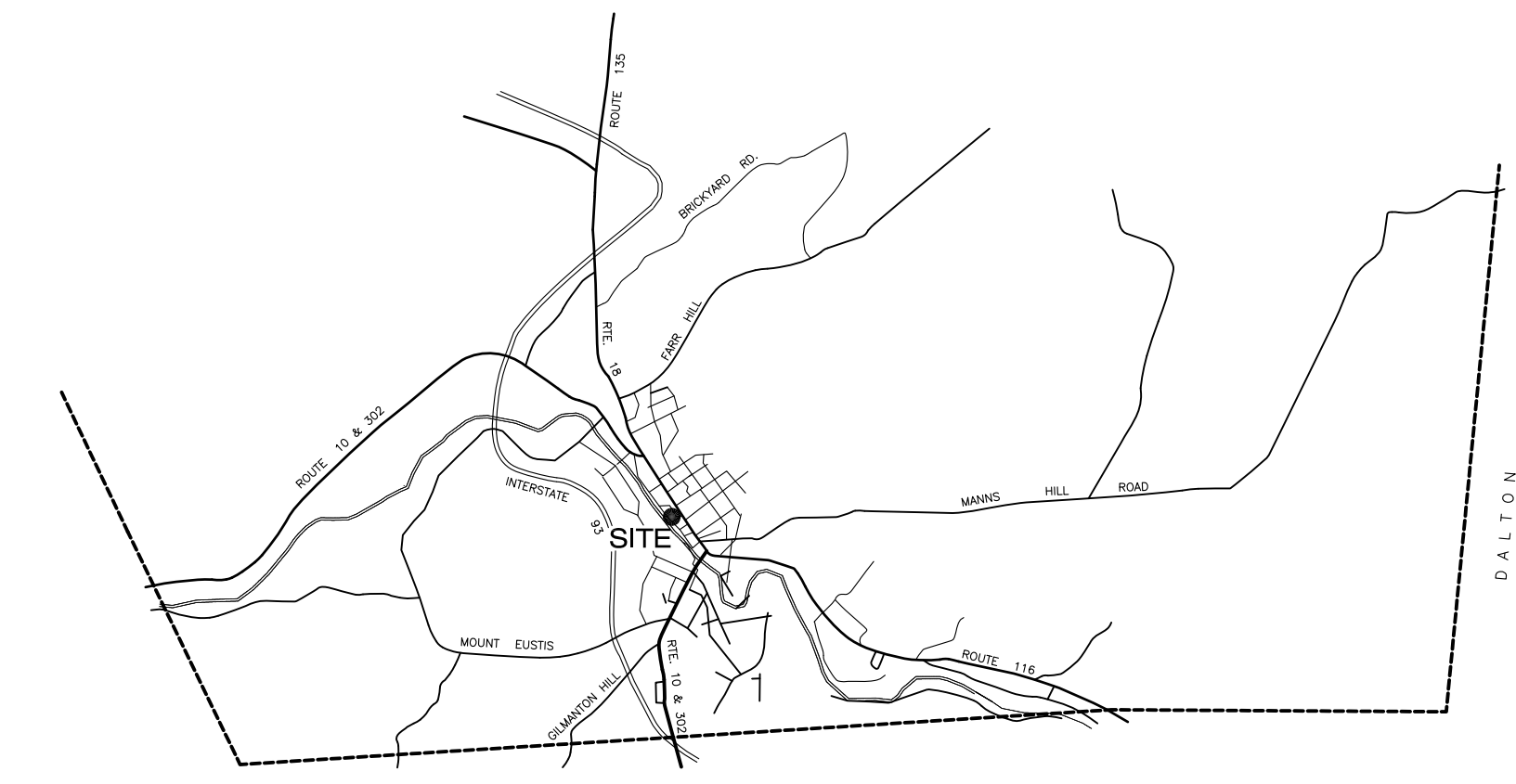

BETHLEHEM
LOCATION MAP
NOT TO SCALE

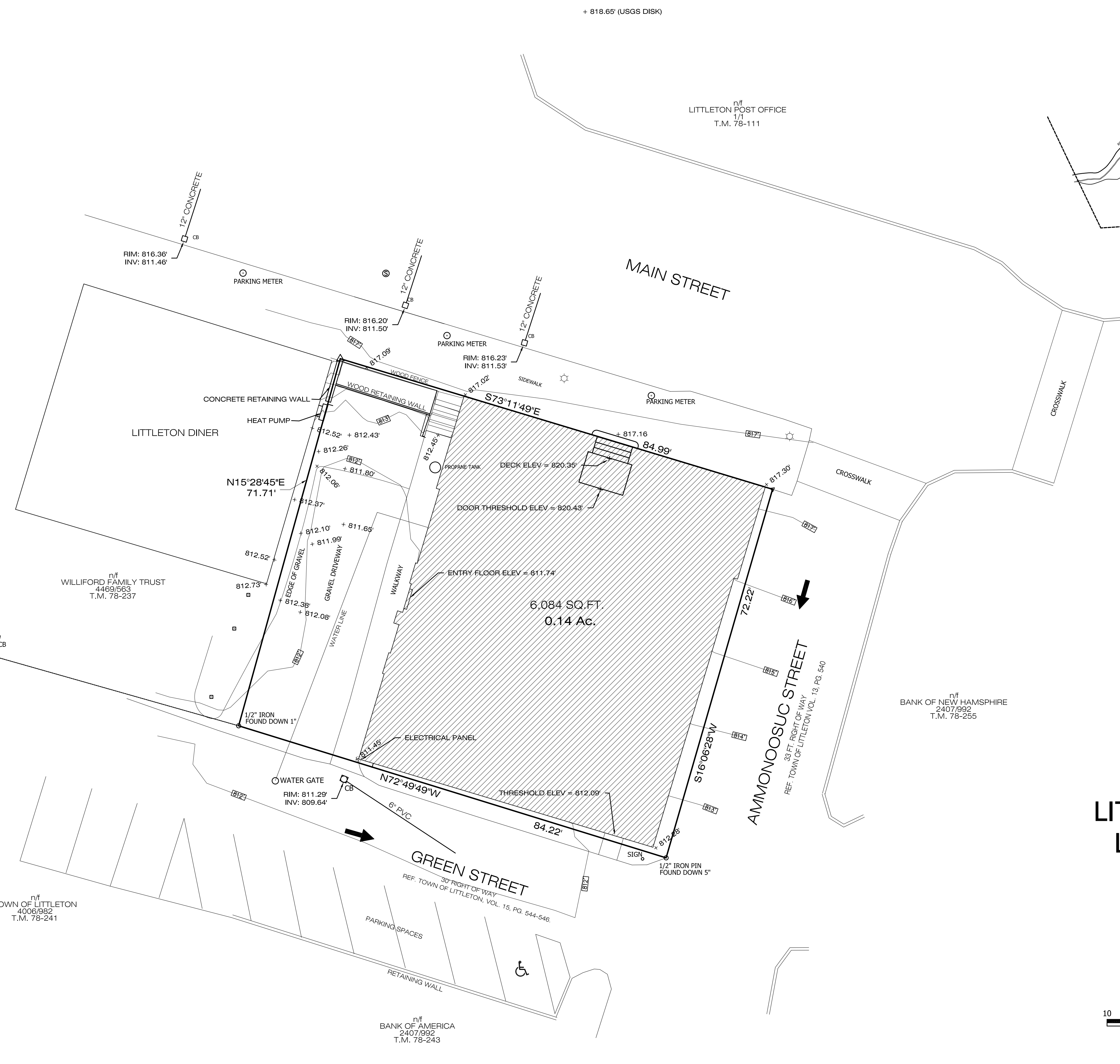
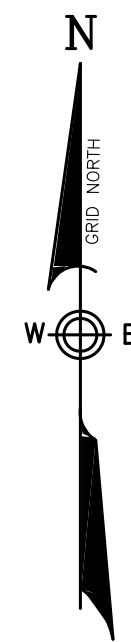

NOTES:

- 1) THIS SURVEY WAS PERFORMED USING GEOMAX ZENITH 35 PRO , GPS RECEIVERS THE POSTIONAL ACCURACY OF MEASUREMENTS HAVE BEEN OBTAINED USING REDUNDANT OBSERVATIONS WHICH MEET THE MINIMUM TOLERANCES SET FORTH BY THE U.S. FEDERAL GEODETIC CONTROL COMMITTEE, APPENDIX b,1988 THE ERROR OF CLOSURE: EXCEEDS 1:10,000
- 2) THIS PROPERTY DOES NOT LIE IN THE FLOOD ZONE REFERENCE F.I.R.M. COMMUNITY PANEL #33009C0117E, FEB. 2008
- 3) REFERENCE PLAN FOR INDIAN HEAD BANK NORTH BY THOMAS MORAN RECORDED G.C.R.D. PLAN 2142 APRIL 1984
- 4) ZONE CI
- 5) NAME & ADDRESS OF OWNER: LITTLETON RIVERSIDE LLC
P.O. BOX 23
LITTLETON, N.H. 03561

SURVEY OF LAND FOR
LITTLETON RIVERSIDE LLC
Littleton, New Hampshire
Grafton County

Reference Deed: Book 4805 Page 561
Tax Map 78 Parcel 238

SURVEYED BY
KELLOGG SURVEYING & MAPPING, INC.
320 Mann's Hill Road Littleton, New Hampshire 03561
(603) 444-2252

July, 2023

Scale: 1" = 10'

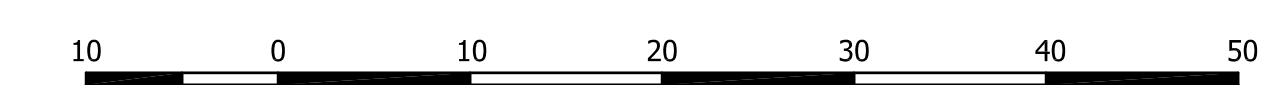

LEGEND:

- UTILITY POLE
- SEWER MANHOLE
- CATCH BASIN
- LIGHT POLE
- CALCULATED POINT

n/f
TOWN OF LITTLETON
4006/982
T.M. 78-241

n/f
WILLIFORD FAMILY TRUST
4469/563
T.M. 78-237

n/f
BANK OF AMERICA
2407/992
T.M. 78-243

n/f
BANK OF NEW HAMPSHIRE
2407/992
T.M. 78-255